

# *Blooming High*®

## *Guide*

Congratulations on your purchase of your Blooming High product. We are sure you will get many years of pleasure from your planter(s).



[www.bloominghigh.co.uk](http://www.bloominghigh.co.uk)

## Contents of your package

First unpack your package and check to make sure you have received all the parts you will need for a successful tower of blooms.

- Container



- 3 Piece Watering Tube



- Your FREE fixing kit to secure multi stacked containers to a wall



- 1 X Hook & Eye (Hook Fitted)



- 2 X Wall Plugs



- 2 X Screws

You will also need Compost, Sharp sand, a wheelbarrow, a trowel and young plants. If you have ordered a fixing kit then you will also need a drill, masonry drill bit and a screwdriver.



Take your planter and stand in position of where you would like it to stay (take note: if you assemble your planter(s) where they are not going to remain they will be heavy to move when filled with compost, sand, plants and water) it is recommended that you fit the fixing kit to the containers and wall/fence before you fill them.

Once positioned mix your compost with your sharp sand at the ratio of 1 part sharp sand to 4 parts compost.

Fill the planter to the first holes, place one plant in each hole and so on until you get three quarters of the way up the planter. At this point you will need to introduce the

one plant in each next set of holes, until you get the watering tube.

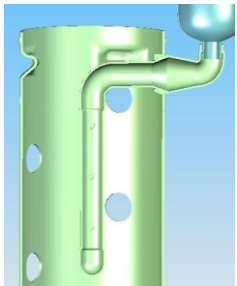

Place into the planter through the hole at the back and push the other into the compost, slot together into place. This tube has been designed to fit together with a soft drink bottle. When feeding/watering fill a 2 litre soft drink bottle with water/food and stand in the watering tube.

At this point you should consider whether you will be joining to your irrigation system, if so see Adding an irrigation system on page 6.



To stack more than 1 planter



Place one on top of the other

drop into the lower one

Add each section until desired height reached

## QUESTION:

Should your Blooming High be supported to a wall to avoid toppling over?



It is recommended that if you are stacking your Blooming High, then you should consider securing it to a wall to avoid it toppling over in high winds etc. They get very heavy when filled and could seriously hurt someone should it fall on them. It is your responsibility to make sure this does not happen.

Each container comes complete with a fixing kit. The kit consists of a hook and eye with fixings. Fix the hook to the tower at the marks located at the top of the rear of the container and line it up with the eye. Fix the eye to a wall using appropriate fixings (the fixings supplied are not guaranteed to be suitable). Hook into place, if you live in a very windy area you could tie your hook to your eye using an appropriate material like a cable tie (recommended) or string. Extra fixing kits are available from Blooming High Ltd or any good DIY retailer.

**Now your Blooming high is complete!**

## Adding An Irrigation System

When adding these containers to your irrigation system, it is recommended that you still install the inner watering tubes that you were supplied. The watering tubes can still be of use for feeding the plants, applying insecticide or just simply topping up with water should a heat wave occur.

In the back of the container is a small hole about 20mm in diameter. This is for your water supply from your irrigation system. Simply pass through the hole a small length of irrigation tube and attach your water outlet device such as a dripper. Set your device according to the manufacturer's instructions making sure you bare in mind how long your system will run for to disperse an appropriate amount of water in that time. The dripper can just lie on the top of the compost or can be staked in place if you prefer. Do this with each container. Stack your containers if necessary then join the small tubes together using elbows, T pieces and more small tubing cut to an appropriate length. Connect your tube to the larger hose that supplies the water to your system.

If you don't already have an irrigation system, they can be purchased at any good garden centre. A small hanging basket kit would be plenty to irrigate these containers and still leave enough spare parts to irrigate your other baskets and containers.

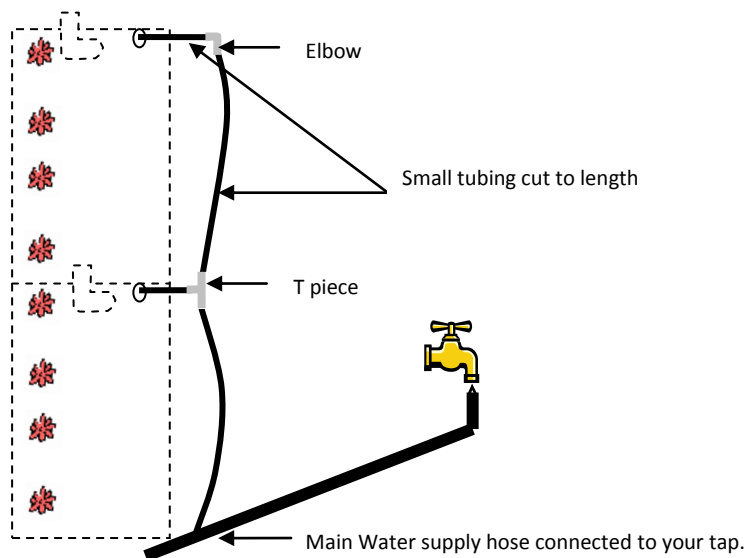

## Tip:



If you need to plant the container with older plants, try using an old carrier bag torn and wrapped around the plant. Then feed the plant through the hole from the inside pushing the end of the bag through the hole. Then gently pull the bag through the hole taking care not to damage the plant inside the bag until the roots are up to the container then remove the bag.

Take a plant, place it on a piece of carrier bag with the roots overlapping



Fold the bag around the plant forming a tube like shape taking care not to damage the branches

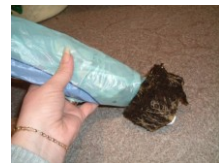

Now feed the bag through the hole from the inside stopping at the root ball. Remove the bag.

# *Blooming High Ltd*

15a High Street  
Bluetown  
Sheerness  
Kent  
ME12 1RN

United Kingdom

 +44 (0)1795 668800

 [sales@bloominghigh.co.uk](mailto:sales@bloominghigh.co.uk)

[www.bloominghigh.co.uk](http://www.bloominghigh.co.uk)

PATENTED PRODUCT  
ALL RIGHTS RESERVED